

Roof Top Car Deck with grouting asphalt pavement

FOAMGLAS® with hot bitumen



Schematic drawing

System 4.5.5

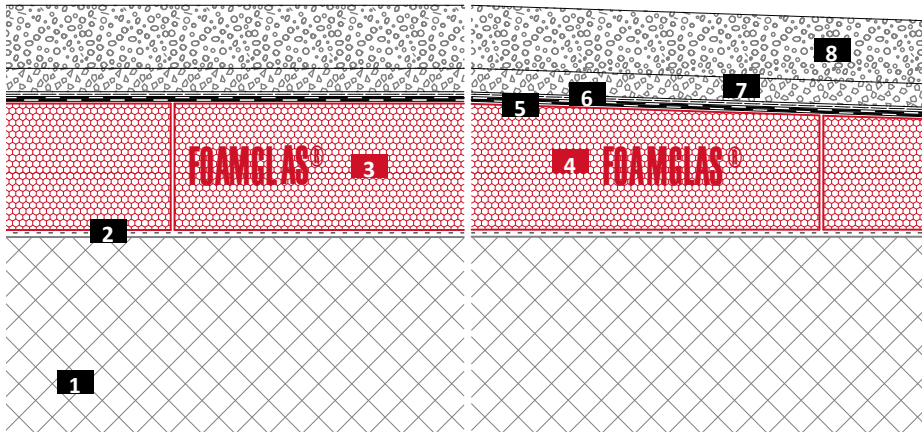

- 1 Concrete roof deck
- 2 Primer coat
- 3 FOAMGLAS®
- 4 FOAMGLAS® TAPERED laid in hot bitumen
- 5 Two layers of bituminous waterproofing membranes, top layer heat resistant
- 6 Separating layer
- 7 Protective layer of mastic asphalt
- 8 Grouting asphalt pavement

FOAMGLAS® product properties

Waterproof – Resistant to vermin – High compressive strength – Non-combustible – Impervious to water vapour – Dimensionally stable – Acid resistant – Easily cut to shape – Ecological

Advantages of the FOAMGLAS® system

- **Quality** : Systems with high quality materials. Quality management by systematic site inspections and professional consulting.
- **Cost efficiency** : The high durability preserves maximum value and guarantees minimal maintenance costs.
- **Sustainability** : Optimum insulation and protection against moisture for generations.
- **Safety** : Compact, fully bonded insulation system preventing large-scale damages and renovations in the event of a leak caused by a puncture of the roofing membrane.
- **Functionality** : Insulation and vapour barrier in one single functional layer. Flexible and easy installation of a gradient through prefabricated tapered slabs.

Recommendations for architect

Normally used:

FOAMGLAS® S3, F (60 x 45 cm),

FOAMGLAS® TAPERED S3, F (60 x 45 cm).

- Insulation thickness to meet building regulations or the project-specific U-value requirements. Please also consult our product overview. It contains information on all our products, their field of application and their specific properties.
- For the use of FOAMGLAS® under load bearing conditions, the project / structural engineer must check the admissible loads.
- The flatness and the general conditions of the substrate are important criteria when using FOAMGLAS® (see TG1). Please contact our Technical Department to verify the criteria for the substrate.
- For a technically correct implementation, relevant standards and guidelines must be observed.

Solutions for technical details and specification clauses on request. Further proposals and solutions are available any time from our technical consultants. **Updated: 01/03/2021.**

We explicitly reserve the right to change the technical specifications. The current values can be found on our website under: uk.foamglas.com/en/building

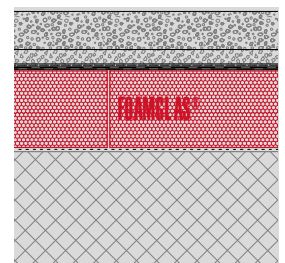

Roof Top Car Deck with grouting asphalt pavement

FOAMGLAS® with hot bitumen



System 4.5.5

Installation instructions

- Apply bituminous primer with roller (or spraying equipment) on the clean and dry concrete surface, coverage ~ 0.3 l/m². (1)
- Apply the FOAMGLAS® slabs fully bonded to the substrate with hot bitumen poured from a bitumen can, with staggered and bitumen-filled butted joints. Coverage ~ 5.0 – 7.0 kg/m², dependent on the thickness of the insulation: Dip a short as well as a long side of the slab in the poured bitumen and press into position against already laid slabs. Surplus bitumen spilt at the side must be removed with the next slab in order to avoid irregularities. (2 / 3)
- Possible waterproofing variation: Apply two layers of bituminous waterproofing membranes covering the entire surface. The first layer is applied using the pour and roll technique, the second is torched on. Joints overlapping at least 100 mm, with staggered courses. Top layer of heat-resistant bituminous waterproofing membrane. (4)
- Apply the separating layer (heat-resistant), with overlapping joints. (5)
- Apply mastic asphalt as a protective layer (~ 30 mm). (6)
- Apply the grouting asphalt pavement, thickness 50 – 100 mm (dependent on load).

Recommendations for the contractor

- The build up and tolerances of the substrate have to be in accordance with relevant standards and guidelines.
- Substrate and ambient temperature should not be below + 5° C.
- A layer of waterproofing membrane must be applied immediately after the insulation has been installed. At the end of each day or every work interruption, all remaining naked surfaces as well as the front sides must be covered with a top coat.
- Protective layers should be applied immediately after the application of the second waterproofing layer.
- Adequate measures should be taken in order to avoid any risks of damage by other contractors during construction.
- Protect sensitive components provided by other suppliers against blobs of hot bitumen and the effect of heat
- Please contact our technical consultants; they can help you by providing support or on-site assistance free of charge.

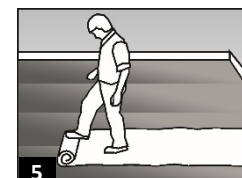
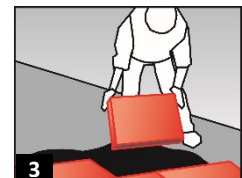
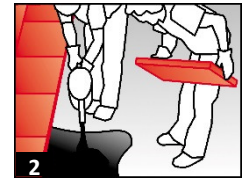
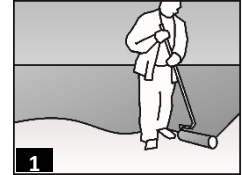

The technical guidelines for the application and the installation of FOAMGLAS® are based on historical experience and general site practice. They do not reflect individual examples. We therefore assume no liability as to the completeness and the suitability for a specific project. Furthermore, our liability and responsibility are subject to our general conditions of sale which are not extended either by this technical data sheet nor by the consulting of our technical sales representatives.

Pittsburgh Corning UK
Limited
31-35 Kirby Street,
London, EC1N 8TE
Phone +44 (0)20 7492 1731
Fax +44 (0)20 7492 1730
info@foamglas.co.uk